

4460/24 SIREN

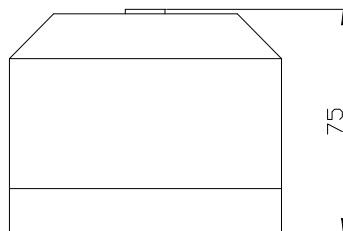
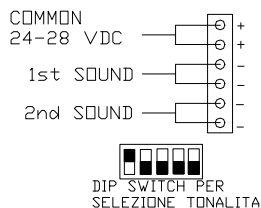
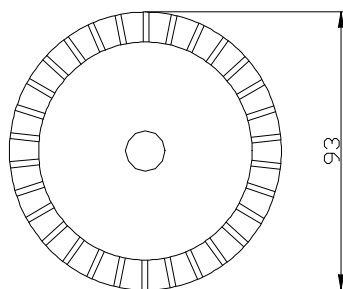

GENERAL DESCRIPTION

An electronic siren designed to be installed in a fire and/or burglar alarm.
 Powerful sound, low consumption.
 Offers 28 different tones that can be selected using the dip-switches and volume control.

TECHNICAL SPECIFICATIONS

Construction: **ABS**
 Connection: **Terminal**
 Power Supply: **24 - 28 Vcc / Vdc**
 Consumption: **18 mA (24 Vcc/Vdc)**
 Sound Pressure: **103 - 105 dB at 1 m**

PIEZOELECTRIC SIREN WITH FLASHING XENON LAMP 3465/24

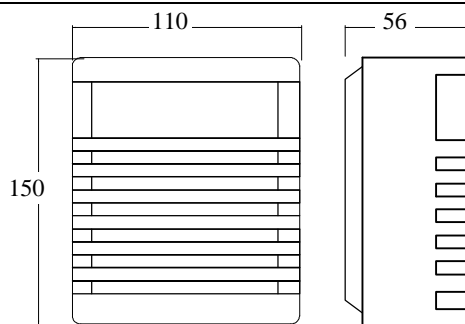

Sizes in mm.

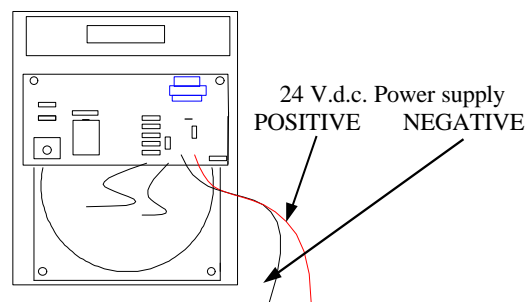

TECHNICAL SPECIFICATIONS

The 3465 / 24 OPTICAL-ACOUSTIC PIEZOELECTRIC SIREN for indoor use features a powerful two-tone sound and flashing XENON light.
 Wire terminals - red = POSITIVE - black = NEGATIVE.
 Sound level : 110 dB at 1 meter.
 Power Supply = 24 V.d.c. Consumption = 200 mA.
 Protection degree = IP 34.
 Weight = 320 g.